

SALIVA ANTIGENTEST

SARS CoV-2 Rapid Antigen Test

CMA-039 | VSCD05-01

CASADA
medical



SARS-CoV-2



C

T



VitroSens is used for the qualitative in vitro detection of SARS-CoV-2 antigen. It is a lateral flow sandwich assay used for the qualitative detection of SARS-CoV-2 nucleocapsid protein antigen in oropharyngeal (OP), nasal (NS), nasopharyngeal (NP) swabs or saliva.

The VitroSens Test Kit can detect SARS-CoV-2 particles within 15 minutes with a sensitivity of 97.3% and a specificity of 99%. VitroSens provides fast and reliable results for you and your loved ones.

VitroSens requires no special equipment or laboratory environment.



RELIABLE

Clinical trials on 437 patients



FAST

Only 15 minutes to results



EASY TO USE

No need for any extra device



Must be used at least two hours after eating or drinking to achieve 95% accuracy.

Manufacturer: Vitrosens Biyoteknoloji LTD. ŞTİ

Şerifali Mh. Şehit Sk. No:17/1 | Ümraniye/Istanbul
E-mail: info@vitrosens.com | Website: www.vitrosens.com

Distributor: Casada International GmbH

Obermeiers Feld 3 | 33104 Paderborn | Germany
info@casada-medical.com | www.casada-medical.com

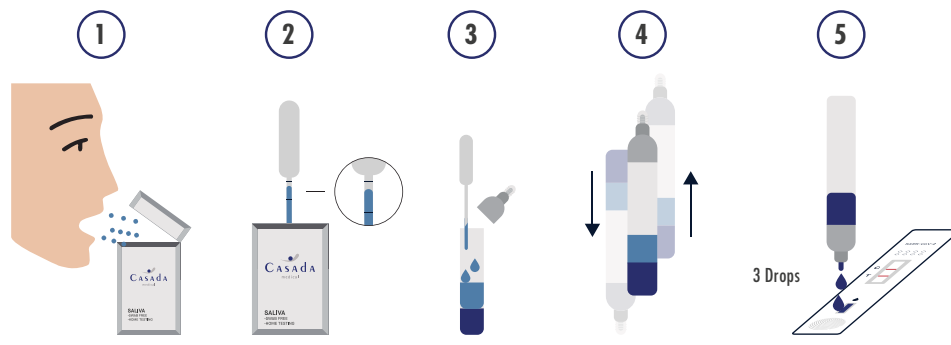

CASADA
medical

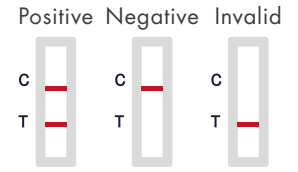

Must be used at least two hours after eating or drinking to achieve 95% accuracy.

Do not use the test kit **after the expiry date**. Bring the sample and test components to room temperature (15-30° C) if necessary and use the appropriate personal protective equipment.

1. Put your saliva into the saliva collection bag.
2. Collect the saliva until the pipette is filled with saliva.
3. Add the saliva to the buffer tube, which is already filled with extraction buffer.
4. Close the cap tightly and mix the solution 10 times by shaking it up and down.
5. Lay the cassette flat and add **3 drops** (~100 µL) of the test sample into the sample well through the top opening of the cap. Read the results after **5 to 15 minutes**.

Wait **5-15 minutes** and read the results. **Do not read results after 30 minutes**. Used materials should be disposed of as biohazardous waste in accordance with local regulations.

Catalog Number	VSCD05-01 CMA-039
Product Format	Cassette
Sample Type	Saliva
Product Number	1
Extra Materials	Extraction Tube + Collection Bag + Package Insert

PERFORMANCE

SENSITIVITY: **95.3%**

SPECIFICITY: **99.1%**

ACCURACY: **97.3%**

Clinical study details:
437 subjects

Testing by the developer (across a number of sites, clinical environments, and operators) demonstrated high quality performance data.

MATERIALS PROVIDED

- 1 tube including extraction buffer
- 1 collecting bag
- 1 pasteur pipette
- 1 test cassette
- 1 package insert

SPECIFICATIONS

Test time: 15 minutes

Sample type: Saliva

Storage: room temperature or refrigerated (2-30° C)

Shelf life: 12 months from date of manufacture